

68TH ST. & MARYLAND DR.

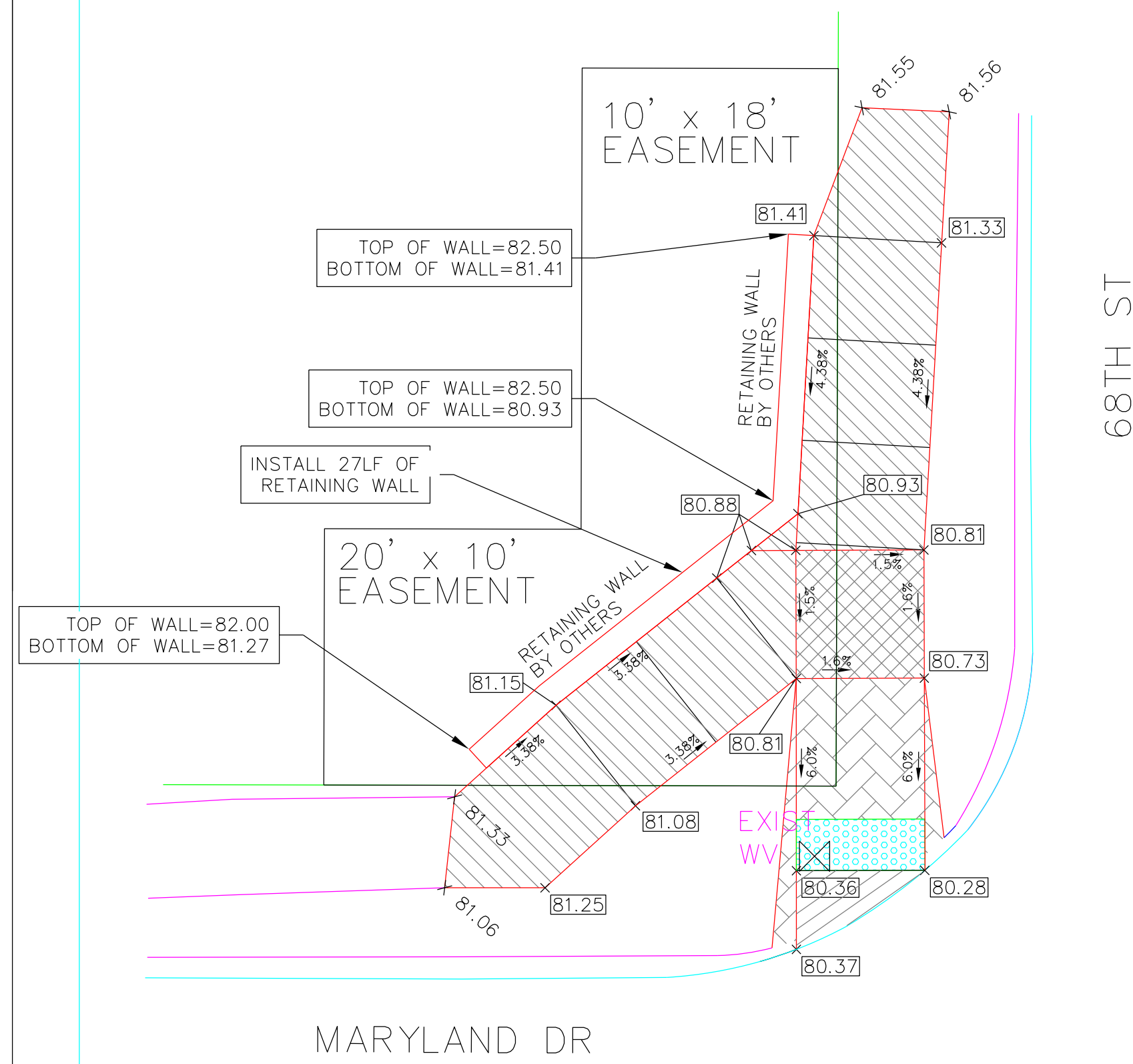

NOTE: BOTTOM OF WALL ELEVATION IS POINT WHERE THE GROUND MEETS THE FACE OF THE RETAINING WALL BY OTHERS.

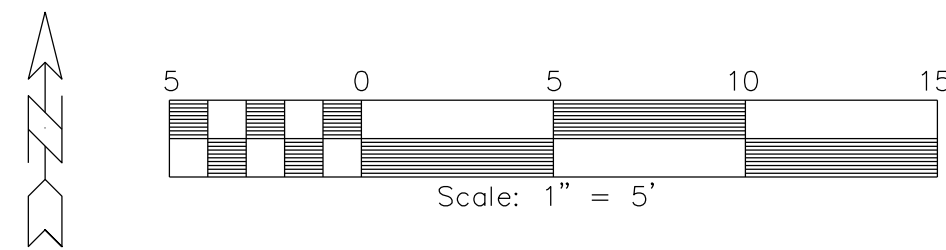

OLIVER SMITH DR. & MARYLAND DR.

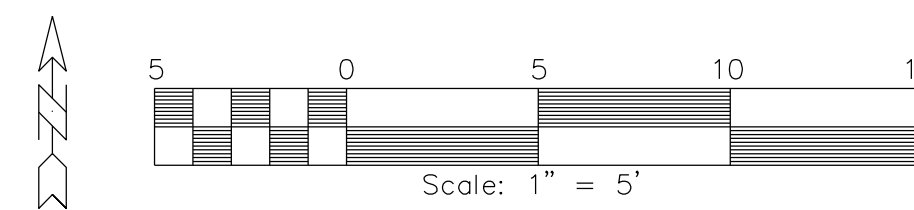
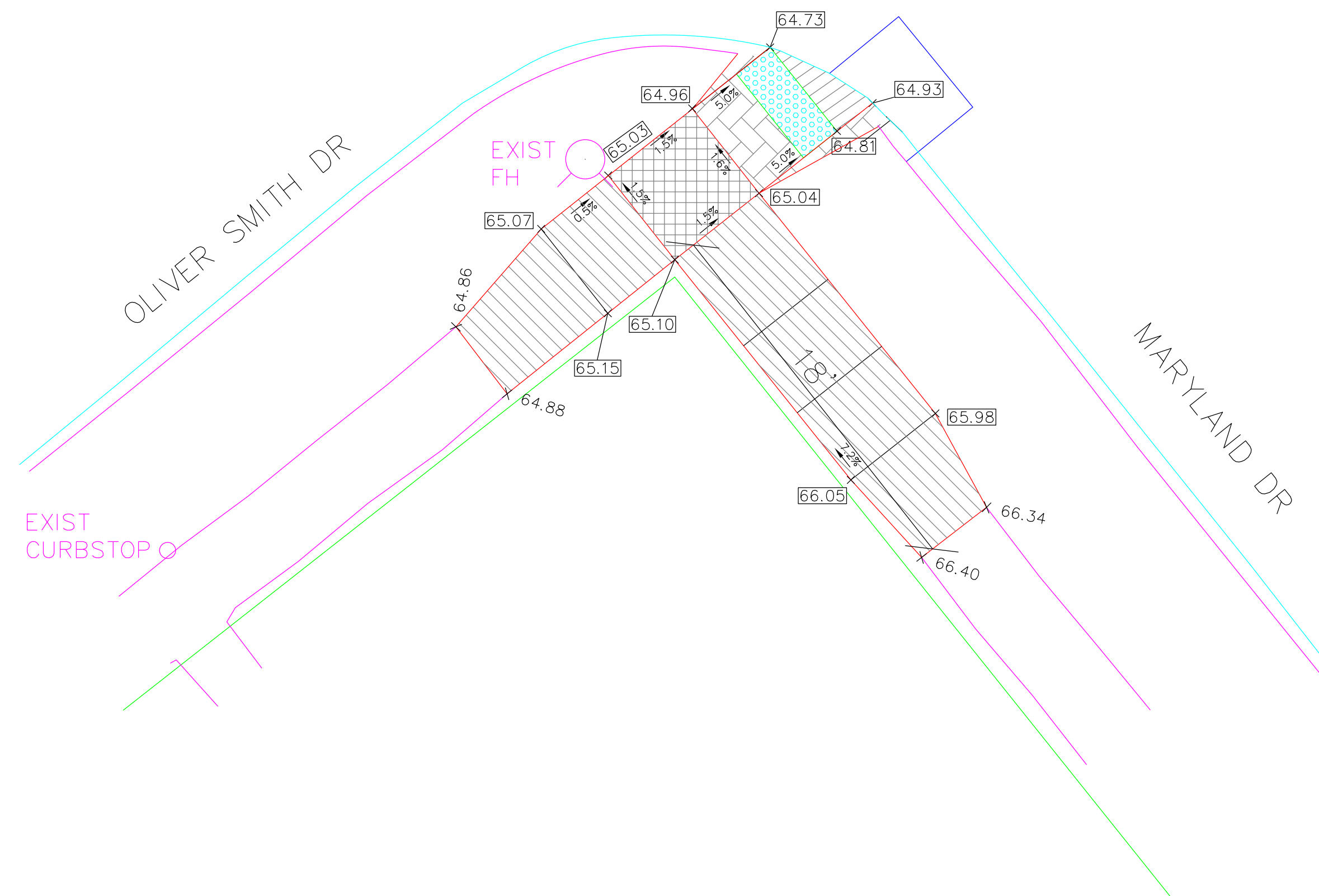

LEGEND - SIDEWALK CONSTRUCTION
NOT TO SCALE

LEGEND

	SIDEWALK - 4"
	RAMP - 6"
	TURNING SPACE - 6"
	DETECTABLE WARNING
	SPECIAL SHAPING - 6"

NOTES ON TARGETS:

RAMP/SIDEWALK CROSS SLOPE:
1.5% TARGET
2.0% MAX

RAMP RUNNING SLOPE:
6.25% TARGET
8.3% MAX

TURNING SPACE, BOTH DIRECTIONS:
1.5% TARGET
2.0% MAX
4' X 4' MINIMUM AT RAMPS

DESIGNED BY: DC
CHECKED BY: DS
DATE 02/09/21 APPROVED BY: JW

URBANDALE WATER UTILITY

SIDEWALK DESIGNS

2021-2 WATER SYSTEM IMPROVEMENT

SHEET
8
OF 9