

67TH ST

67TH ST. & MADISON AVE.

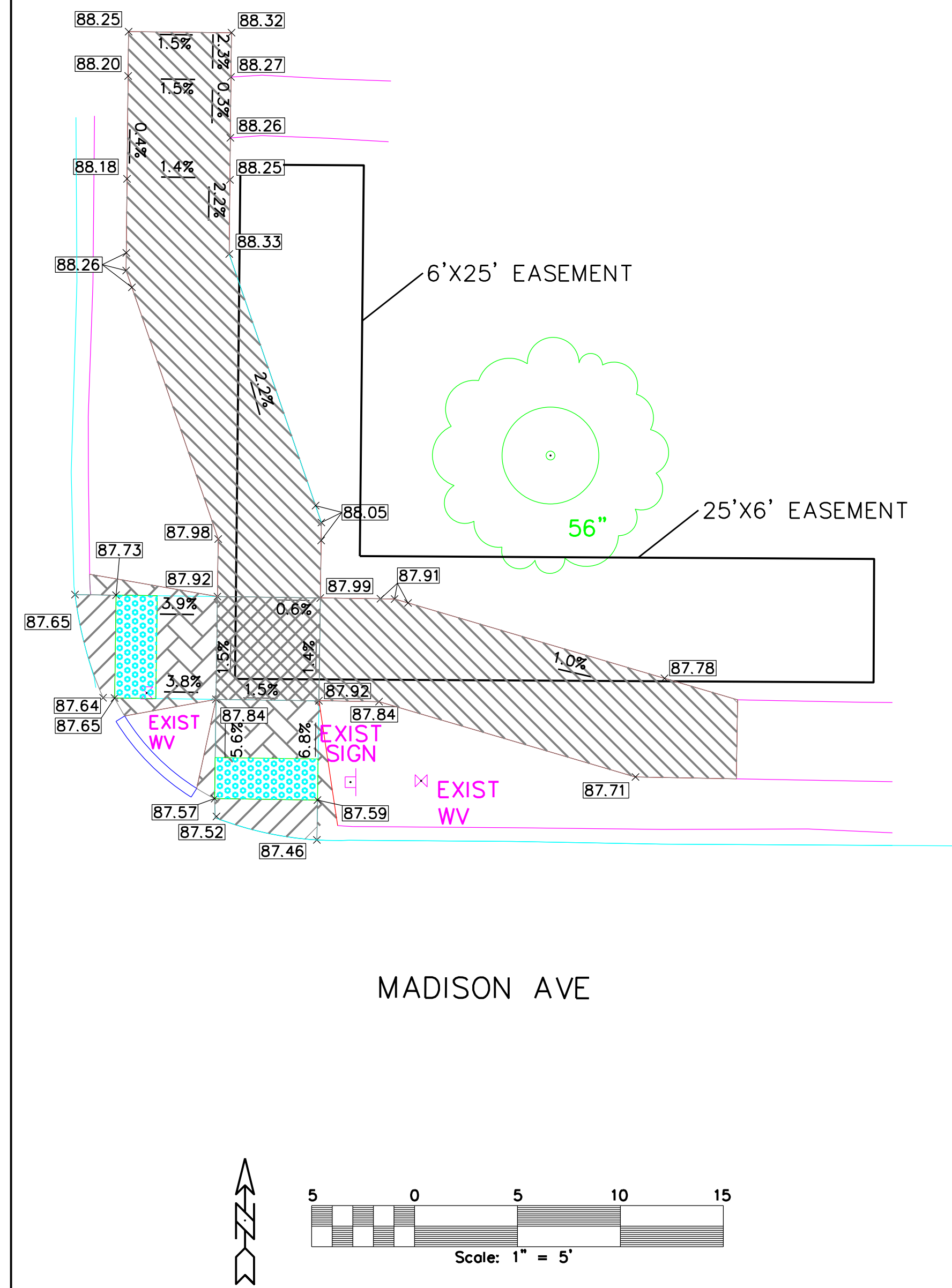

67TH ST. & AIRLINE AVE.

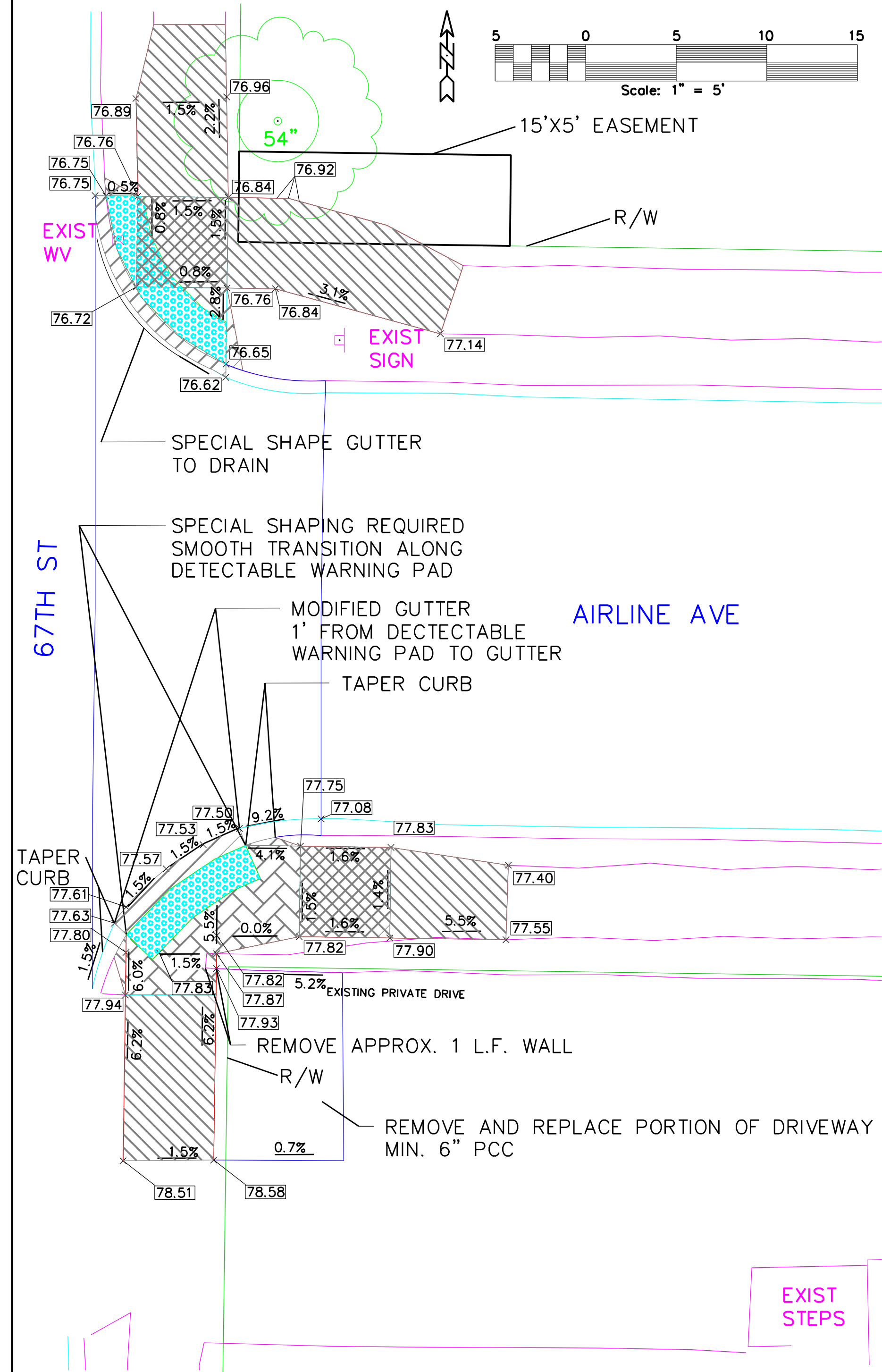

LEGEND - SIDEWALK CONSTRUCTION
NOT TO SCALE

- LEGEND
- SIDEWALK - 4"
 - RAMP - 6"
 - TURNING SPACE - 6"
 - DETECTABLE WARNING
 - GRADE BREAK

NOTES ON TARGETS:

RAMP/SIDEWALK CROSS SLOPE:
1.5% TARGET
2.0% MAX

RAMP RUNNING SLOPE:
6.25% TARGET
8.3% MAX

TURNING SPACE, BOTH DIRECTIONS:
1.5% TARGET
2.0% MAX
4' X 4' MINIMUM AT RAMPS

THE EASTERN PEDESTRIAN RAMPS AT THE INTERSECTION OF 67TH ST. AND AIRLINE AVE QUALIFIES AS A PROWAG DESIGN EXCEPTION DUE TO EXISTING GEOMETRIC SITE CONSTRAINTS.

	<p>ENGINEERING CERTIFICATION</p> <p>I HEREBY CERTIFY THAT THIS ENGINEERING DOCUMENT, SPECIFICATION OR REPORT WAS PREPARED BY ME, OR UNDER MY DIRECT PERSONAL SUPERVISION, AND THAT I AM A DULY LICENSED PROFESSIONAL ENGINEER UNDER THE LAWS OF THE STATE OF IOWA.</p> <p>DOUGLAS J. SALTSGAVER, P.E. #11993 DATE 12/16/2020 MY REGISTRATION RENEWAL DATE IS DECEMBER 31, 2020</p>
	<p>PAGES OR SHEETS COVERED BY THIS SEAL</p> <p>687</p>

DESIGNED BY: JW
CHECKED BY: GP
APPROVED BY: DA
DATE 12/16/20

URBANDALE WATER UTILITY

SIDEWALK DESIGNS

2021-1 WATER SYSTEM IMPROVEMENT

SHEET
6
OF 7