

GUTTER LINE ELEVATIONS

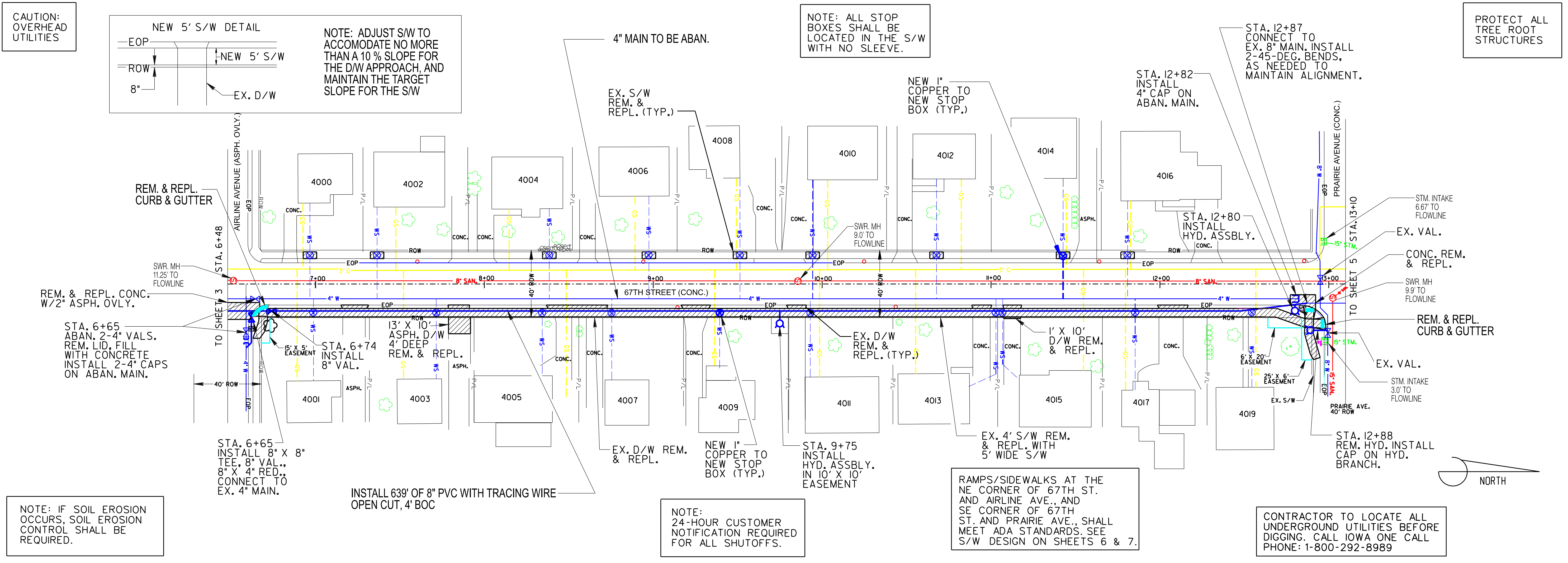

NOTE: IF SOIL EROSION OCCURS, SOIL EROSION CONTROL SHALL BE REQUIRED.

INSTALL 639' OF 8" PVC WITH TRACING WIRE OPEN CUT, 4' BOC

NOTE: 24-HOUR CUSTOMER NOTIFICATION REQUIRED FOR ALL SHUTOFFS.

RAMPS/SIDEWALKS AT THE NE CORNER OF 67TH ST. AND AIRLINE AVE., AND SE CORNER OF 67TH ST. AND PRAIRIE AVE., SHALL MEET ADA STANDARDS. SEE S/W DESIGN ON SHEETS 6 & 7.

CONTRACTOR TO LOCATE ALL UNDERGROUND UTILITIES BEFORE DIGGING. CALL IOWA ONE CALL PHONE: 1-800-292-8989

SCALE HORZ 1"=30'
 VERT 1"=5'
 DATE: 12/14/2020

DRAWN BY JW
 CHECKED BY GP
 CHECKED BY DA

URBANDALE WATER UTILITY

67TH STREET – AIRLINE AVENUE TO PRAIRIE AVENUE

2021-1 WATER SYSTEM IMPROVEMENTS

SHEET 4 OF 7