

GUTTER LINE ELEVATIONS

0+00 1+00 2+00 3+00 4+00 5+00 6+00

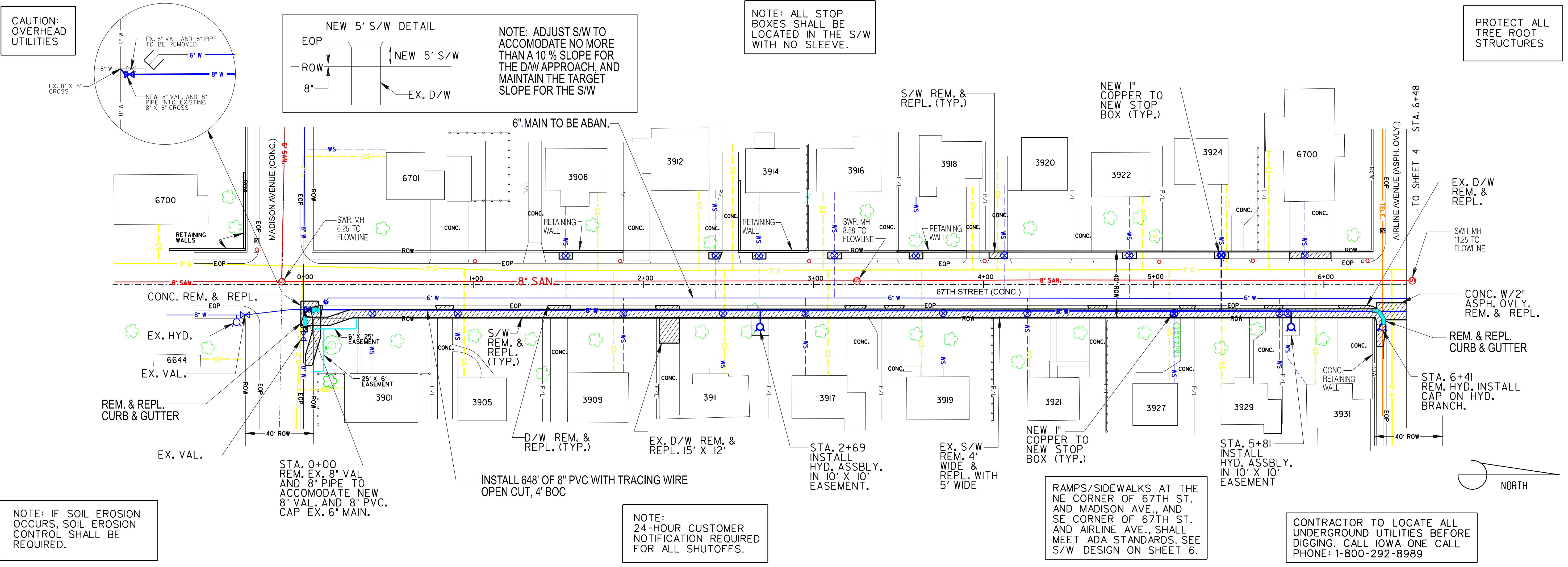

CAUTION: OVERHEAD UTILITIES

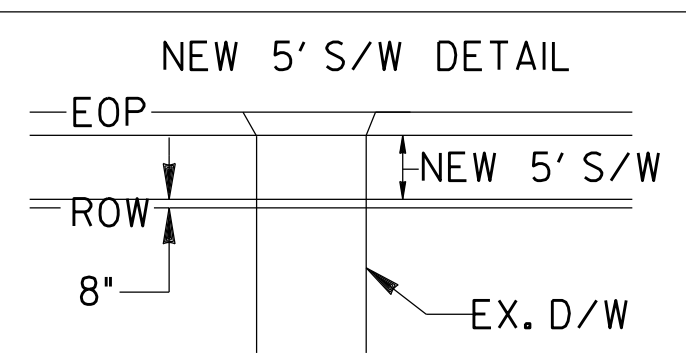
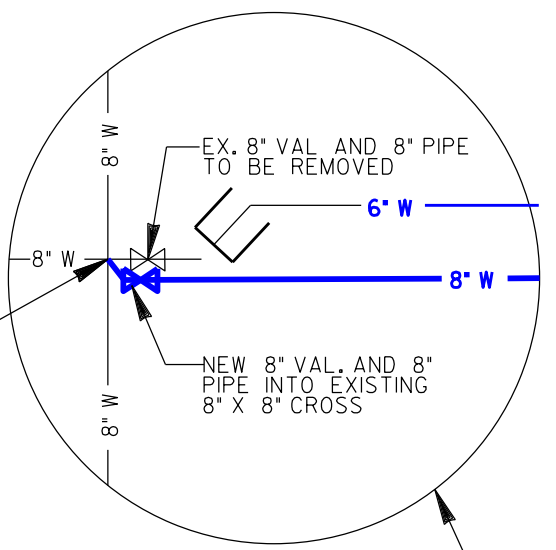

NOTE: ADJUST S/W TO ACCOMODATE NO MORE THAN A 10% SLOPE FOR THE D/W APPROACH, AND MAINTAIN THE TARGET SLOPE FOR THE S/W

NOTE: ALL STOP BOXES SHALL BE LOCATED IN THE S/W WITH NO SLEEVE.

PROTECT ALL TREE ROOT STRUCTURES

NOTE: IF SOIL EROSION OCCURS, SOIL EROSION CONTROL SHALL BE REQUIRED.

STA. 0+00 REM. EX. 8\"/>

INSTALL 648' OF 8\"/>

NOTE: 24-HOUR CUSTOMER NOTIFICATION REQUIRED FOR ALL SHUTOFFS.

STA. 2+69 INSTALL HYD. ASSBLY. IN 10' X 10' EASEMENT.

EX. S/W REM. 4' WIDE & REPL. WITH 5' WIDE

RAMPS/SIDEWALKS AT THE NE CORNER OF 67TH ST. AND MADISON AVE., AND SE CORNER OF 67TH ST. AND AIRLINE AVE., SHALL MEET ADA STANDARDS. SEE S/W DESIGN ON SHEET 6.

CONTRACTOR TO LOCATE ALL UNDERGROUND UTILITIES BEFORE DIGGING. CALL IOWA ONE CALL PHONE: 1-800-292-8989

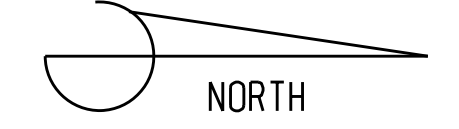

SCALE HORZ 1"=30'	DRAWN BY JW
VERT 1"=5'	CHECKED BY GP
DATE: 12/14/2020	CHECKED BY DA

URBANDALE WATER UTILITY

67TH STREET – MADISON AVENUE TO AIRLINE AVENUE

2021-1 WATER SYSTEM IMPROVEMENTS

SHEET 3 OF 7